

# ULTRA-MINIATURE 2-PORT NORMALLY CLOSED HIGH DENSITY INTERFACE (HDI®) SOLENOID VALVE

The Lee Company continues to redefine miniature fluidics with an even more compact High Density Interface (HDI®) solenoid valve. Featuring an ultra-miniature 2-port normally closed design, this valve is exceptionally lightweight, and offers consistent performance throughout its life.

This miniature solenoid valve is ideal for applications with tight envelope constraints such as handheld or benchtop molecular diagnostic instruments, patient simulators, breath analyzers, environmental monitors, and portable respiratory care instruments. The plug-in and face mount style manifold mount options allow for a multitude of valves to be employed in a compact array while the ported style valve allows flexibility in mounting stand-alone valves within challenging envelopes. The low power consumption and low leakage rating across life are further examples of the exceptional performance and long-standing reliability offered by our best-in-class HDI solenoid valve platform.

For additional information and technical assistance, please visit our website or contact your Lee Sales Engineer.

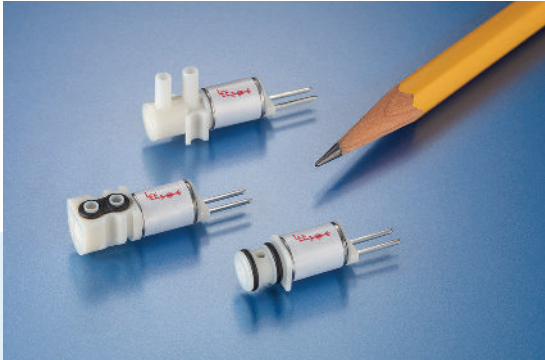

- Ultra-compact size
- Light weight: less than 2.5 grams
- Low internal volume
- Low power consumption
- Operating pressure range: Vac-45 psig (0-10 psid)
- Leakage: less than 50  $\mu$ LPM at 10 psid air, 70°F (21°C)
- Wetted materials: housing (PBT), armature/core (FeCr Alloy), spring (316 SS), O-Ring (FKM) and epoxy. See table below for seal and plunger head wetted materials.

STYLE	PART NUMBER	VOLTAGE SPIKE/HOLD <sup>1</sup> (Vdc)	LOHM <sup>2</sup> RATE ON AIR AT 70°F (21°C)	HOLD POWER CONSUMPTION (mW)	WETTED MATERIALS	
					SEAL	PLUNGER HEAD
Plug-In	LHDB0442145D	12.0 / 3.5	450 Lohms (14.6 SLPM at 10 psid; Cv = 0.044)	440	Silicone	PPS
	LHDB0442245D	12.0 / 3.5			FKM	PPA
	LHDB0942145D	24.0 / 7.0		420	Silicone	PPS
	LHDB0942245D	24.0 / 7.0			FKM	PPA
	Face Mount	LHDB0342115H		3.3 / 2.0	1500 Lohms (4.4 SLPM at 10 psid; Cv = 0.013)	310
LHDB0542115H		5.0 / 3.0				
LHDB1242115H		12.0 / 7.2				
LHDB0352115H		3.3 / 2.0				
LHDB0552115H		5.0 / 3.0				
Ported	LHDB1262145D	12.0 / 2.8	450 Lohms (14.6 SLPM at 10 psid; Cv = 0.044)	350	Silicone	PPS
	LHDB1262245D	12.0 / 2.8			FKM	PPA
	LHDB2462145D	24.0 / 5.6			Silicone	PPS
	LHDB2462245D	24.0 / 5.6			FKM	PPA

NOTES: (1) Spike and hold drive required for continuous duty. Reference Lee Drawing Number LFIX1002250A or LFIX1002450B for schematic recommendations. For low duty applications when a spike and hold drive may not be required, contact The Lee Company for drive profile recommendations.  
 (2) The Lohm is a measure of flow resistance. Additional information can be found at [www.theleeco.com](http://www.theleeco.com).

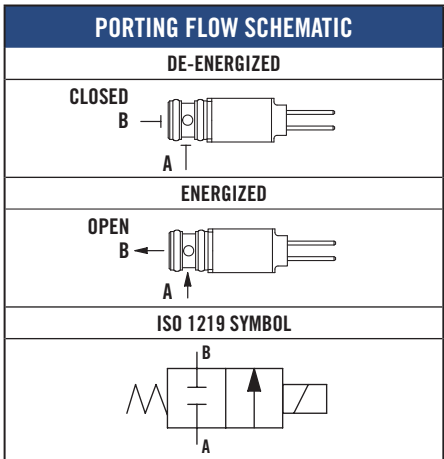

See dimensional drawings on reverse.

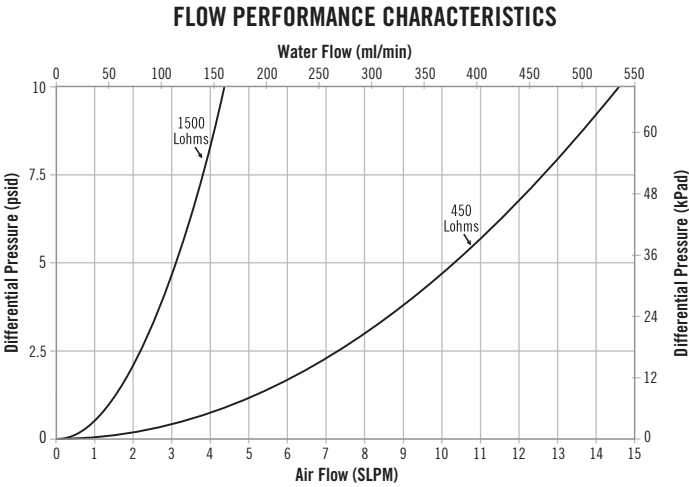

## 2-PORT NORMALLY CLOSED SOLENOID VALVE

### PLUG-IN

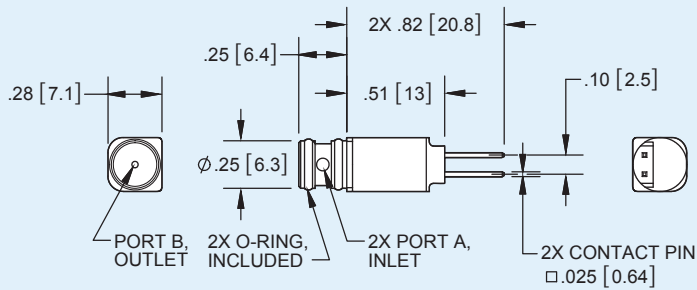

### FACE MOUNT

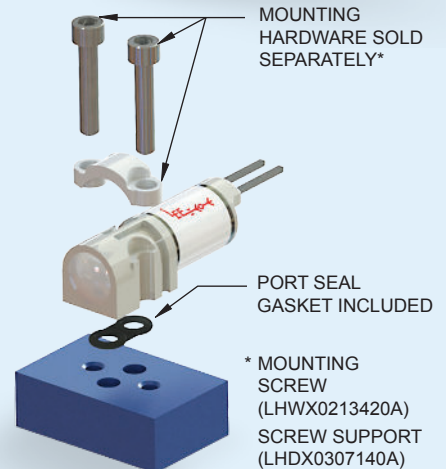
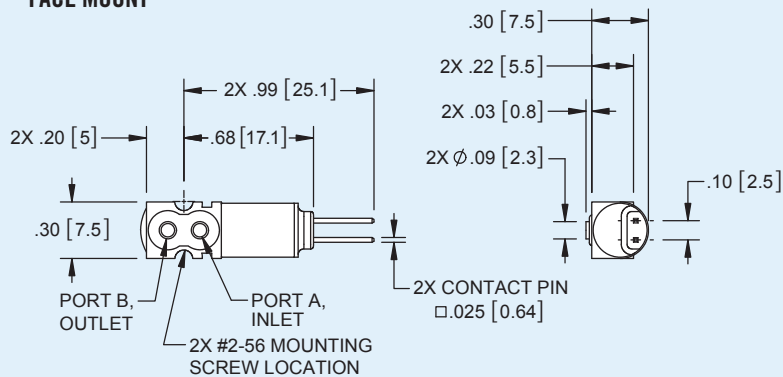

### PORTED

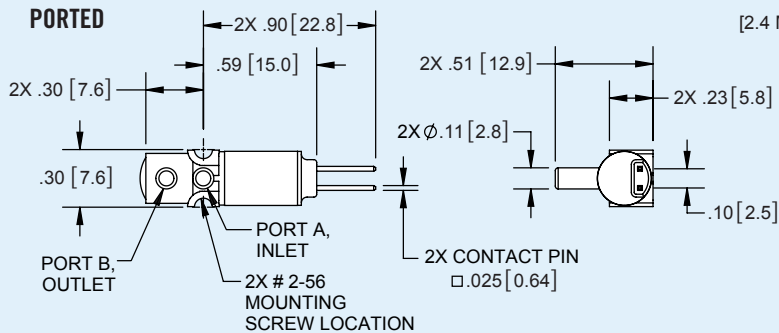

FOR USE WITH 3/32"  
[2.4 MM] ID, 5/32" [4.0 MM]  
MAX OD TUBING

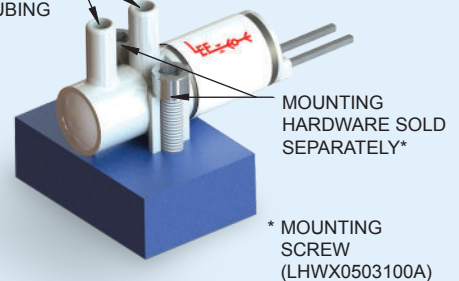

### PLUG-IN BOSS

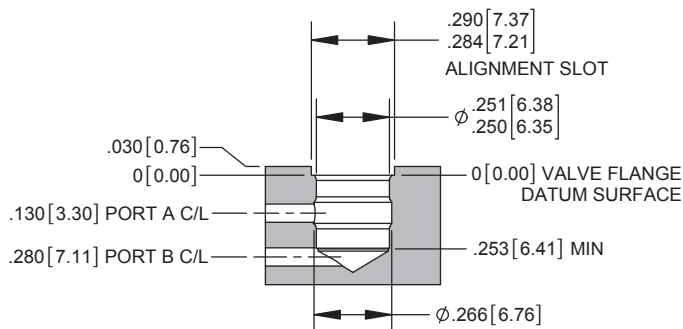

### FACE MOUNT BOSS

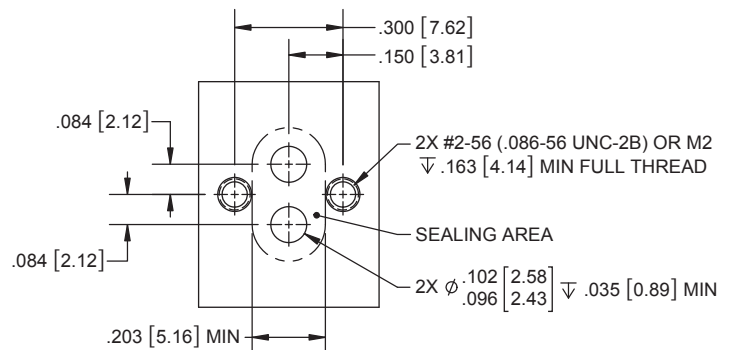

Boss geometries and dimensions shown above are for reference only. All dimensions are in inches [mm]. Reference Drawing Number LCFX0300250B for complete Plug-In Boss specifications and Drawing Number LFIX1002050A for complete Face Mount Boss specifications.

Plug-In Boss geometry may be created using Lee cutting tool Part Number TTTA0000250B.